



GMV



Submersible pumps with vortex impeller in cast iron EN-GJL-250 pag. 250

GMVS



Submersible pumps with vortex impeller in cast iron with polyurethane coating pag. 257

GMC

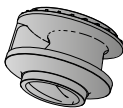

Submersible pumps with single channel impeller in cast iron EN-GJL-250 pag. 259

GMN



Submersible pumps with channels impeller in cast iron EN-GJL-250 pag. 268

GMG



Submersible pumps with grinder in cast iron EN-GJL-250 pag. 282

I-GMV



Submersible pumps with vortex impeller in stainless steel AISI316 pag. 286

I-GMC



Submersible pumps with single channel impeller in stainless steel AISI316 pag. 286

I-GMN



Submersible pumps with channels impeller in stainless steel AISI316 pag. 286

B-GMV



Submersible pumps with vortex impeller in Marine Bronze B10 pag. 297

B-GMC

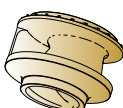

Submersible pumps with single channel impeller in Marine Bronze B10 pag. 297

B-GMN



Submersible pumps with channels impeller in Marine Bronze B10 pag. 297

A new series of submersible pumps with high efficiency hydraulics designed to move slurry, sewage and industrial process fluids.

The range covers a wide field of use with head up to 75 m And flows up to 2300 m³/h, with a maximum solid passage up to 140 mm keeping the risk of blockage to a minimum. Dimensionally designed for heavy demand, even on critical applications.

Explosion proof version on request.

Pump designation

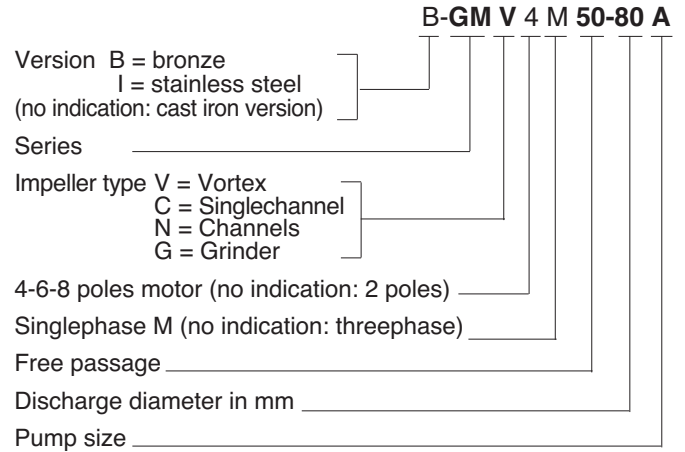

Coverage chart

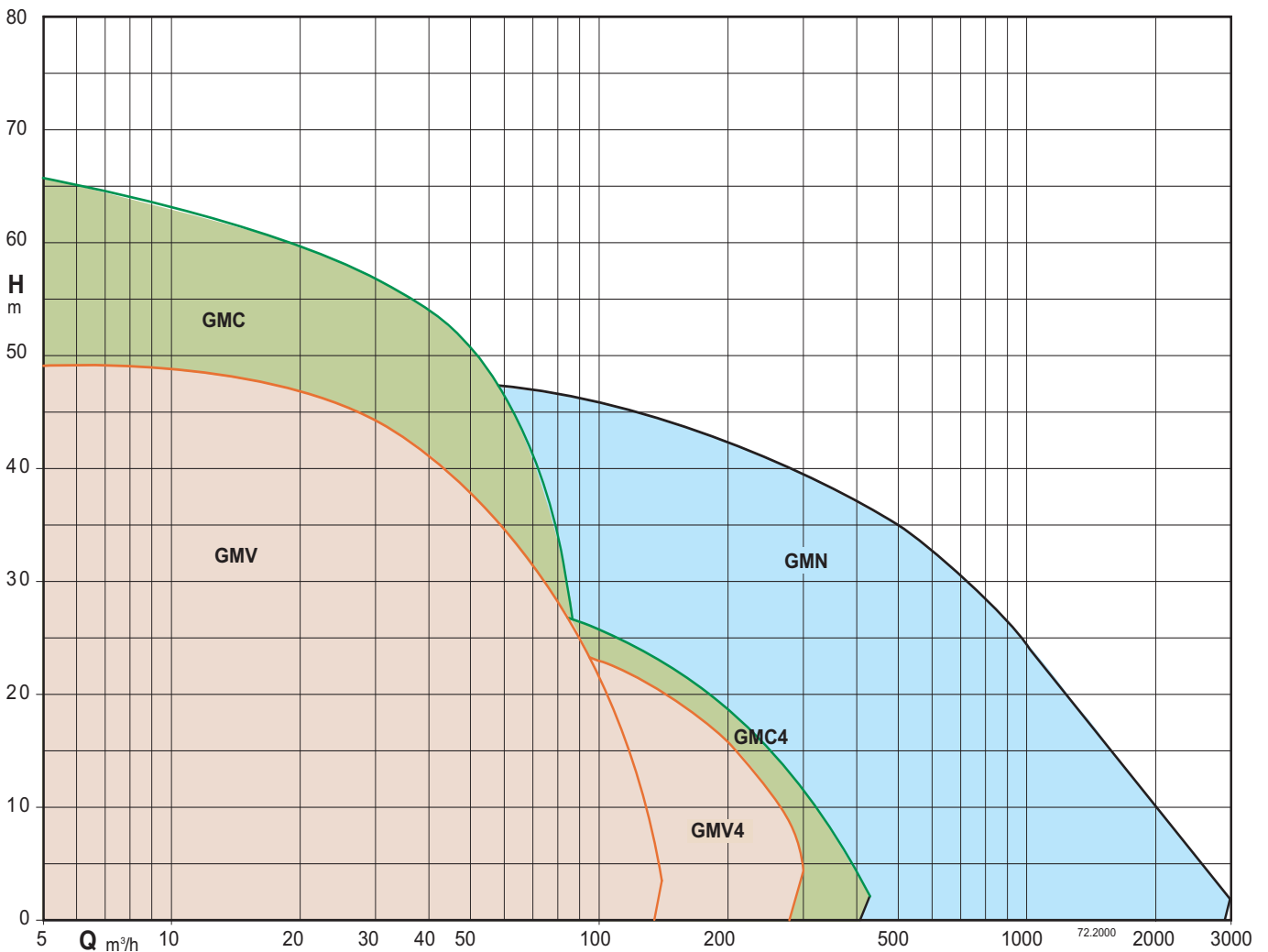

Tolerances according to ISO 9906, annex A.



Construction

Submersible pumps with single channel impeller.
Twin mechanical seal with oil chamber (lip-seal motor side up to 1,4 kW).
Delivery connection DN 50-65-80-100-150

Applications

Suitable to pump slurry, sewage, waste water (non-corrosive).
In industrial and residential installations and drainag applications
Solid passage from 40 to 100mm

Operating conditions

Liquid temperature up to 40 °C.
Maximum immersion depth: 20 m (with suitable cable length).
Continuous duty (with pump immersed at minimum level).

Motor

2 or 4 poles induction, 50Hz
Single-phase version: 230V ± 10%, with float switch and built-in capacitor.
Three-phase version: 400V ± 10%, up to 3,2 kW
400/690V ± 10%, over 3,2 kW
Insulation class: H
Protection degree: IP 68
N° of starting x hour: max 15 with regular intervals
Cable: H07RN-F, length 10 m
Other models: contact our sale office

Main materials

Pump casing: cast iron EN-GJL-250 - Impeller: cast iron EN-GJL-250+Ni
Motor casing, Motor cover: cast iron EN-GJL-250
Motor shaft: stainless steel AISI 420B
Lip seal made of nitrile up to 1,4 kW
Mechanical seal motor side: graphite/ceramic over 1,4 kW
Mechanical seal pump side: silicon carbide/silicon carbide

Coverage chart

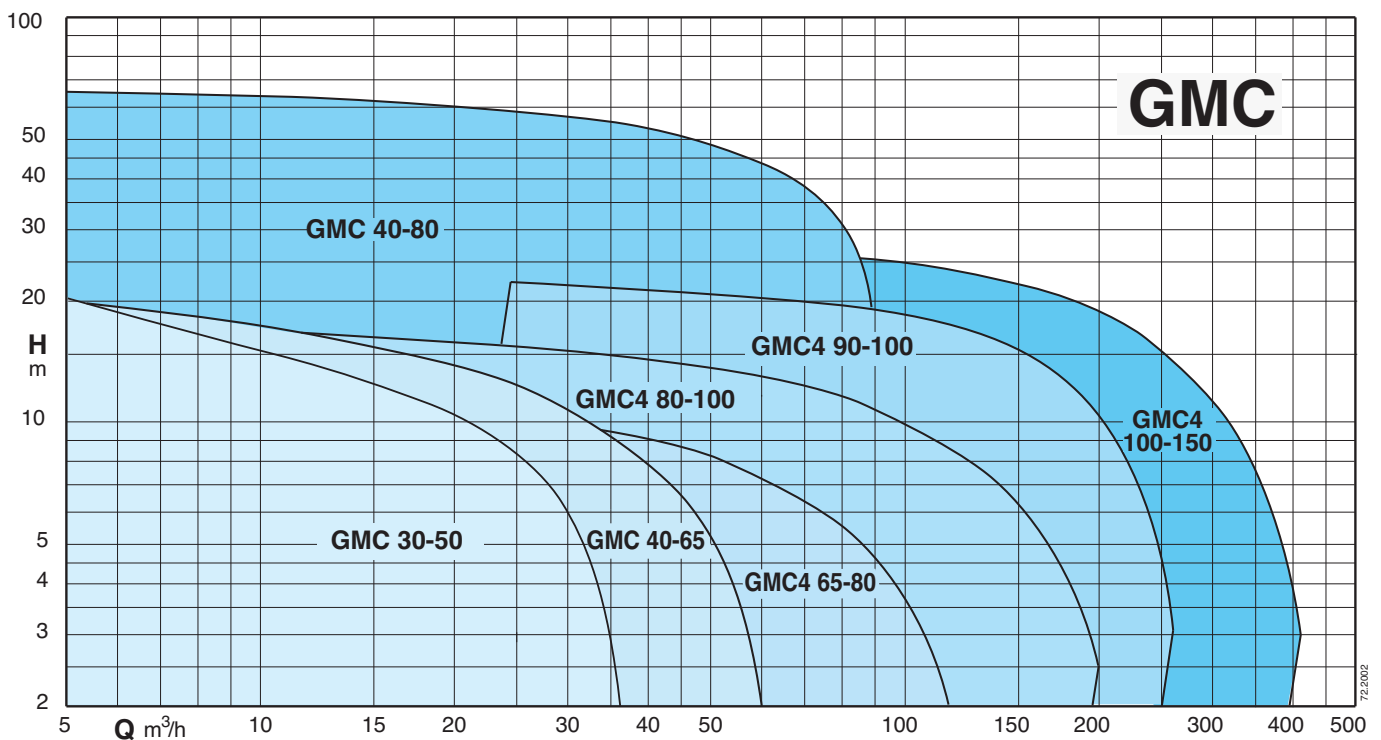

Technical data

TYPE	P ₂ kW	I _N A	Power Supply	r.p.m.	Starting	DN mm	Free passage Ø mm	Thermal protector	Humidity probe	ATEX Eex
GCMC 30-50B	1,1	7,5	1~ 230V	2850	D.O.L.	50	30	●	NO	
GMC 30-50B	1,4	3	3~ 400V	2850	D.O.L.	50	30	NO	NO	
GMC 30-50A	1,4	3	3~ 400V	2850	D.O.L.	50	30	NO	NO	
GCMC 40-65B	1,8	10	1~ 230V	2850	D.O.L.	65	40	NO	NO	✓
GMC 40-65B	2,4	5	3~ 400V	2850	D.O.L.	65	40	NO	NO	✓
GMC 40-65A	2,9	6	3~ 400V	2850	D.O.L.	65	40	NO	NO	✓
GMC 40-80D	13,8	29,5	3~ 400/690V	2850	Y/Δ	80	40	●	●	✓
GMC 40-80C	13,8	29,5	3~ 400/690V	2850	Y/Δ	80	40	●	●	✓
GMC 40-80B	18,2	34	3~ 400/690V	2850	Y/Δ	80	40	●	●	✓
GMC 40-80A	18,2	34	3~ 400/690V	2850	Y/Δ	80	40	●	●	✓
GMC4M 65-80C	1,2	8,5	1~ 230V	1450	D.O.L.	80	65	●	NO	✓
GMC4 65-80C	1,3	3,5	3~ 400V	1450	D.O.L.	80	65	NO	NO	✓
GMC4 65-80B	2,3	5	3~ 400V	1450	D.O.L.	80	65	NO	NO	✓
GMC4 65-80A	2,8	6,5	3~ 400V	1450	D.O.L.	80	65	NO	NO	✓
GMC4 75-80A	2,8	6,5	3~ 400V	1450	D.O.L.	80	75	NO	NO	✓
GMC4 80-100C	3,8	8	3~ 400/690V	1450	Y/Δ	100	80	●	●	✓
GMC4 80-100B	3,8	8	3~ 400/690V	1450	Y/Δ	100	80	●	●	✓
GMC4 80-100A	5	11	3~ 400/690V	1450	Y/Δ	100	80	●	●	✓
GMC4 90-100B	11,6	23,2	3~ 400/690V	1450	Y/Δ	100	90	●	●	✓
GMC4 90-100A	14,4	29,5	3~ 400/690V	1450	Y/Δ	100	90	●	●	✓
GMC4 100-150C	14,4	29,5	3~ 400/690V	1450	Y/Δ	150	100	●	●	✓
GMC4 100-150B/A	17,8	32,5	3~ 400/690V	1450	Y/Δ	150	100	●	●	✓
GMC4 100-150A/A	21	43,1	3~ 400/690V	1450	Y/Δ	150	100	●	●	✓

 P₂ Rated power output

 I_N Rated current

● Standard

✓ ATEX Eex Version on demand

Characteristic curves

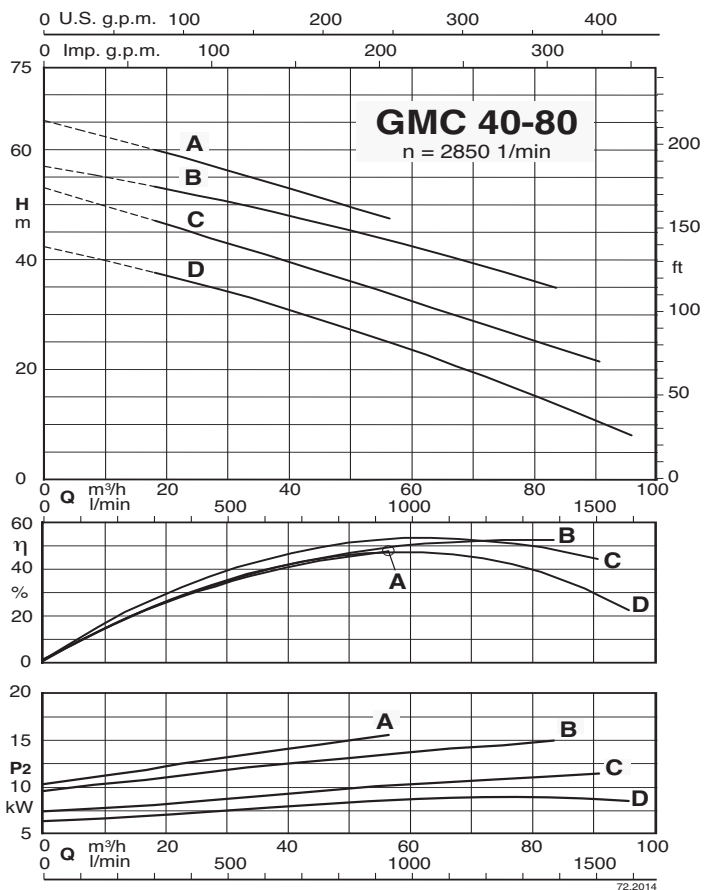
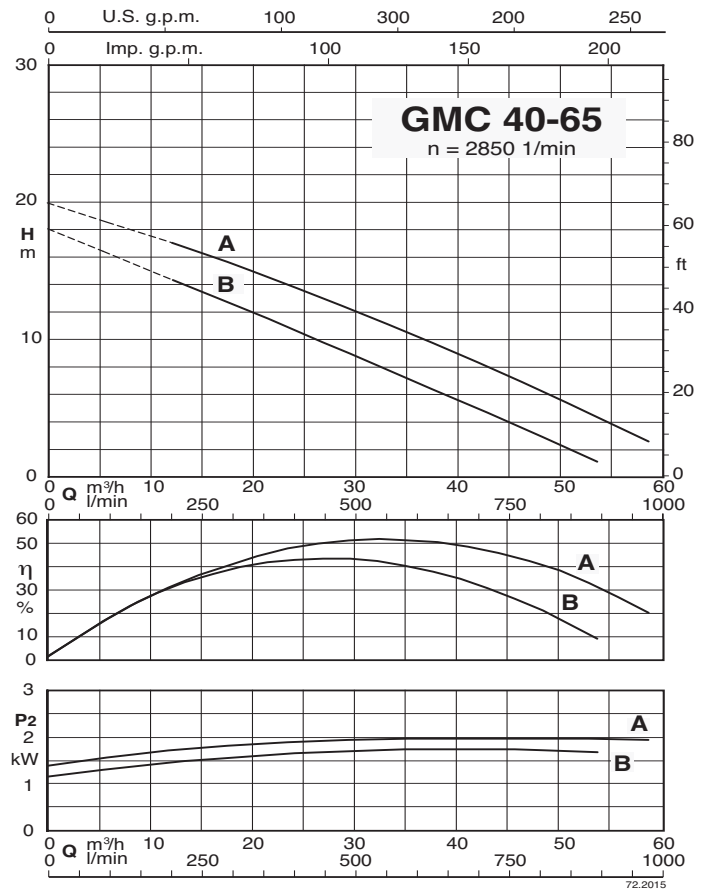
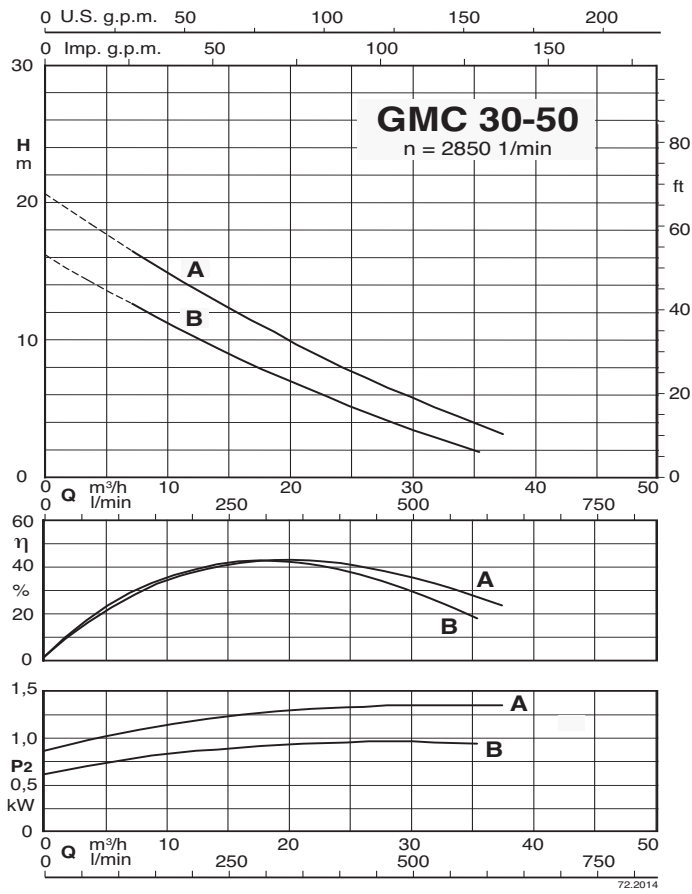

Characteristic curves

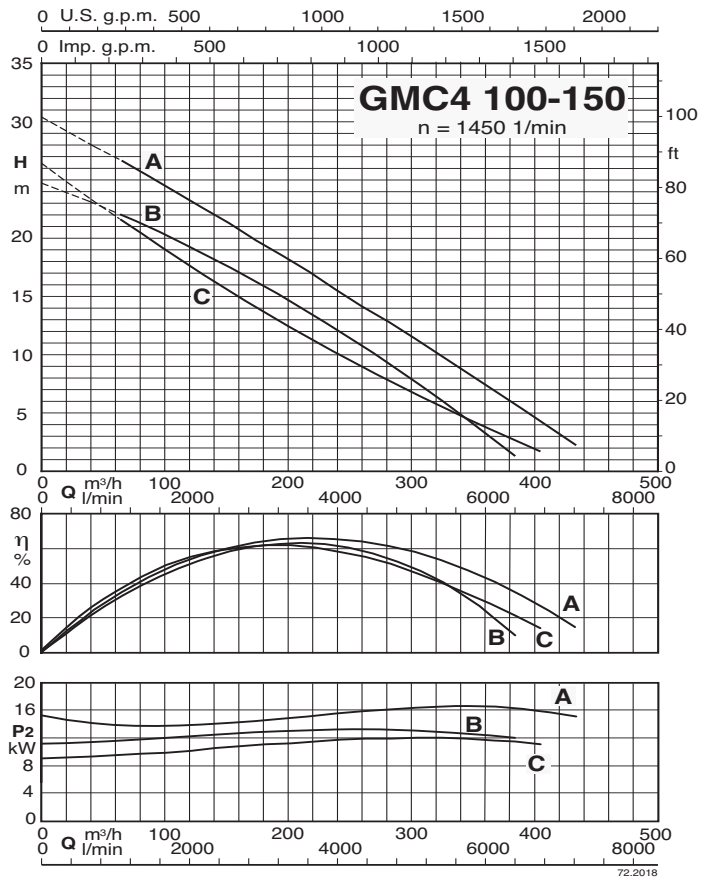
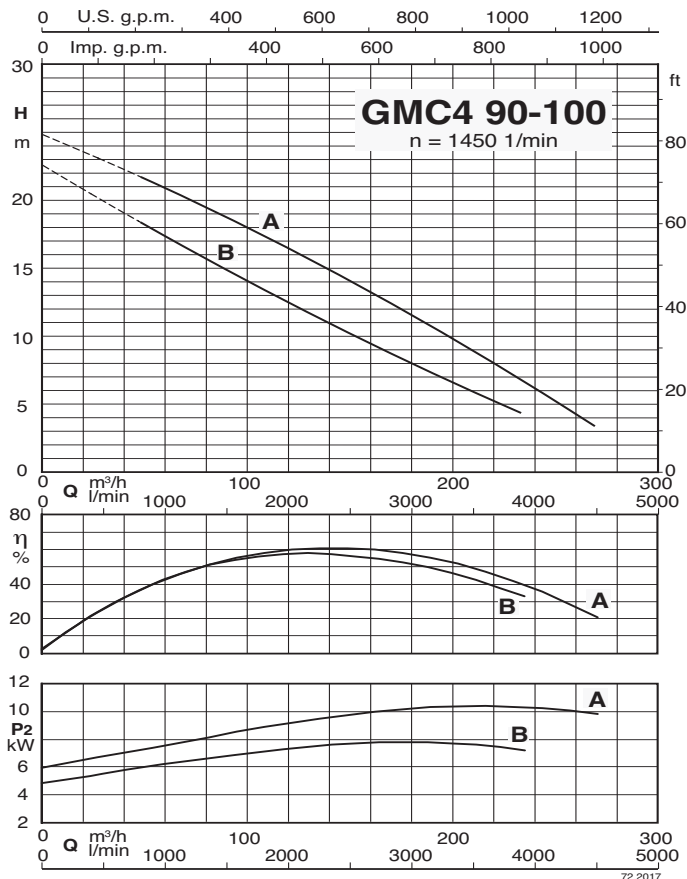
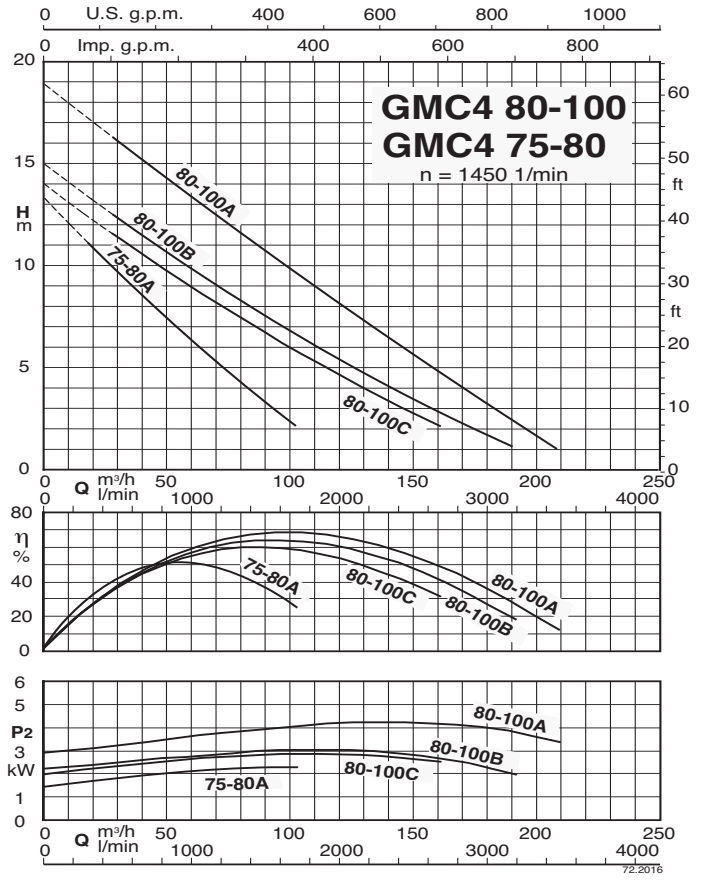
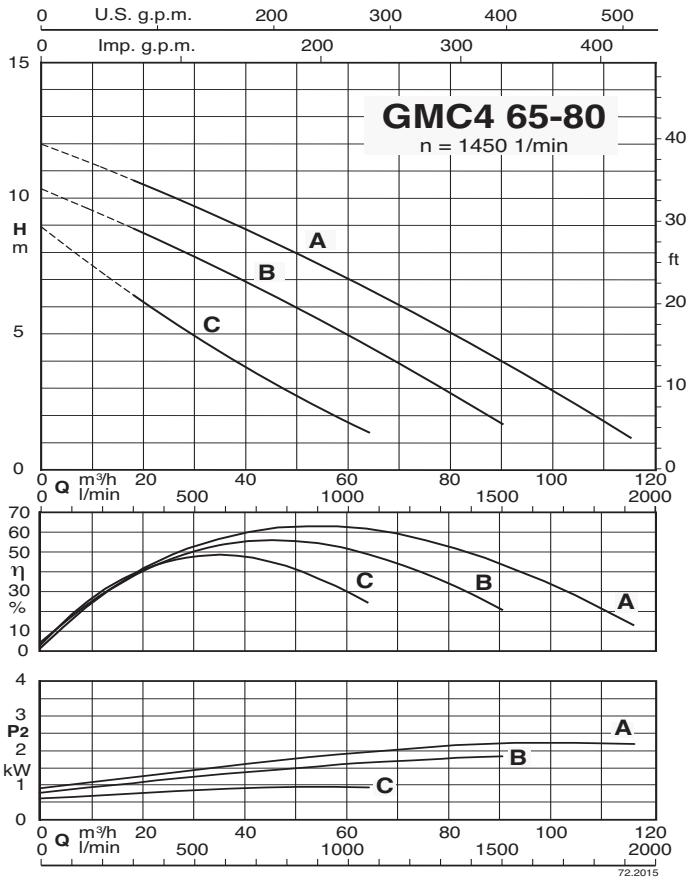

Dimensions and weights

GMC 30-50

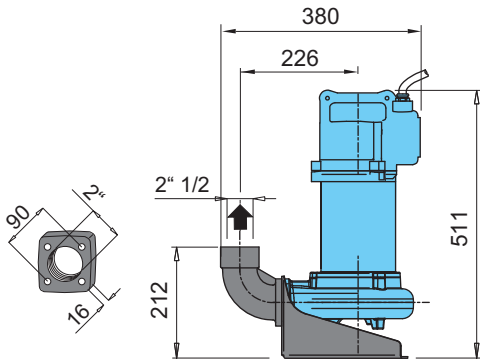
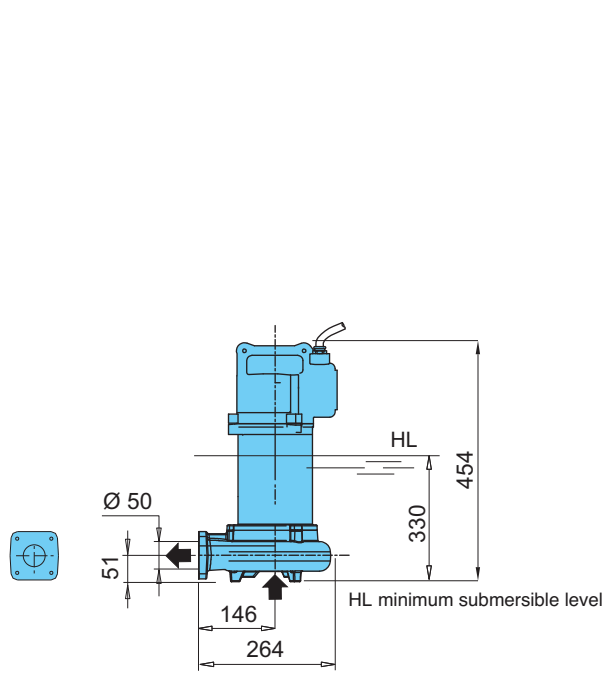

Version with foot and 90° elbow

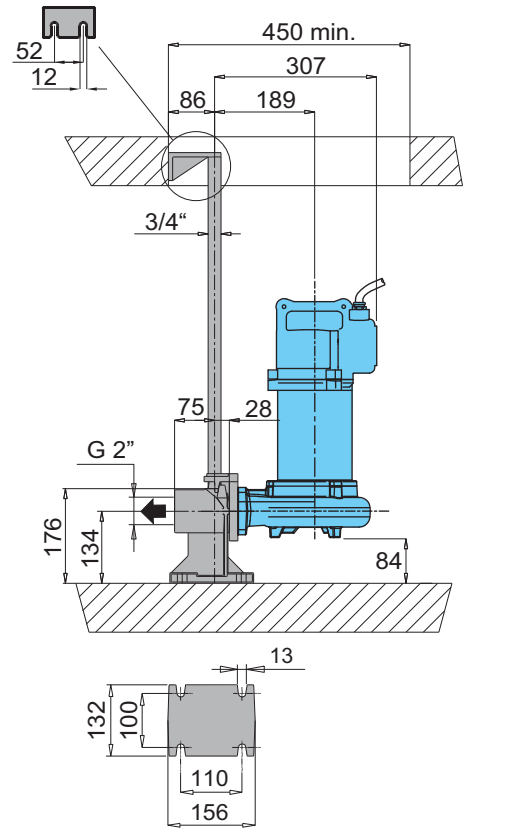

Version with duck foot coupling

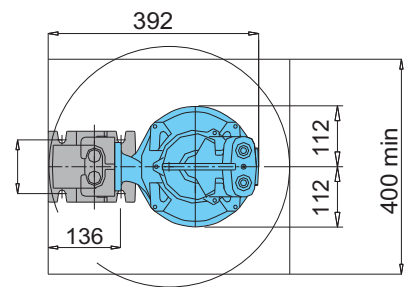

TYPE	Weight kg
GMCM 30-50B	45
GMC 30-50B	
GMC 30-50A	

Dimensions and weights

GMC 40-65

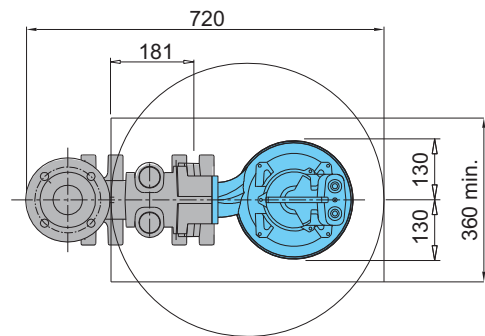
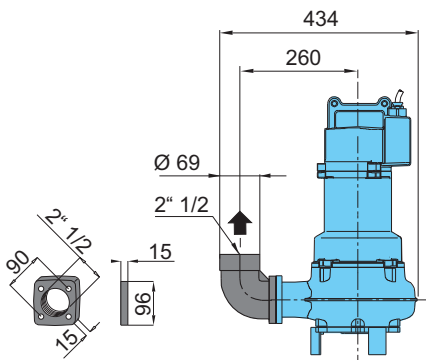
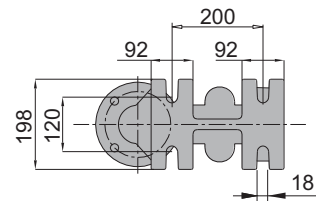
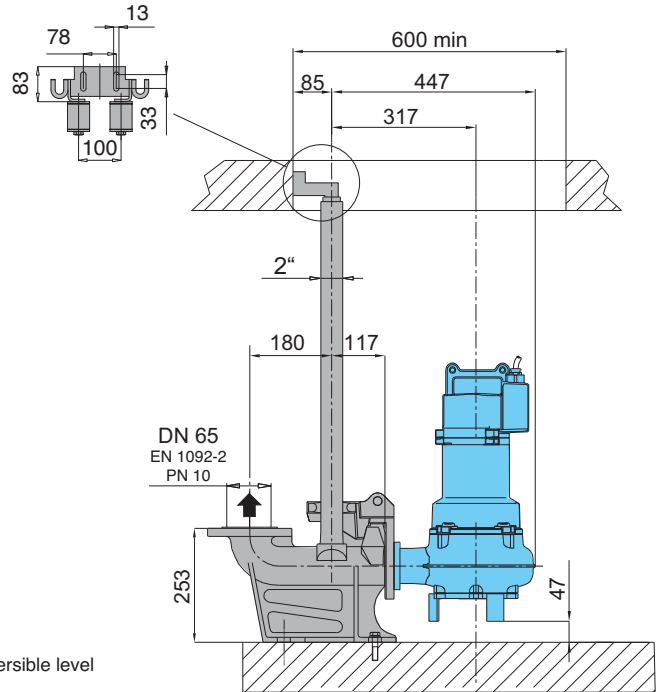
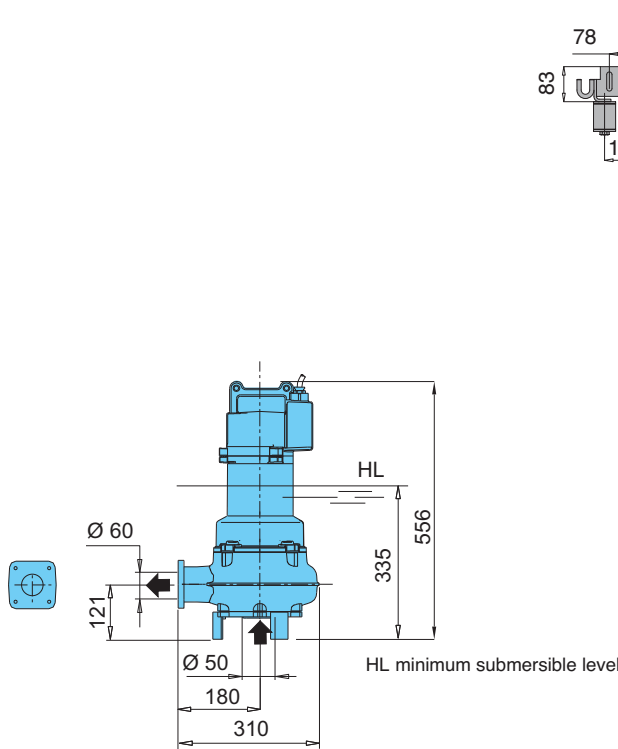

Version with foot and 90° elbow

Version with duck foot coupling

TYPE	Weight kg
GMCM 40-65B	45
GMC 40-65B	
GMC 40-65A	

Dimensions and weights

- GMC 40-80**
- GMC4M 65-80**
- GMC4 65-80**
- GMC4 75-80**

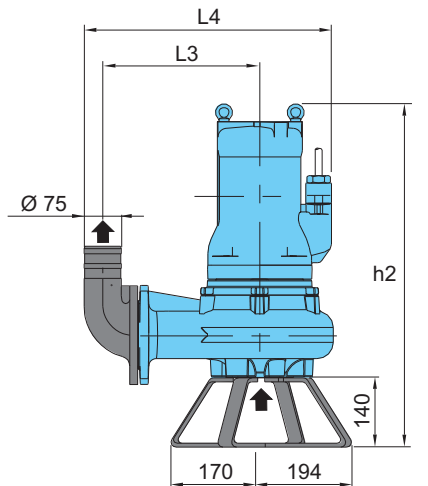
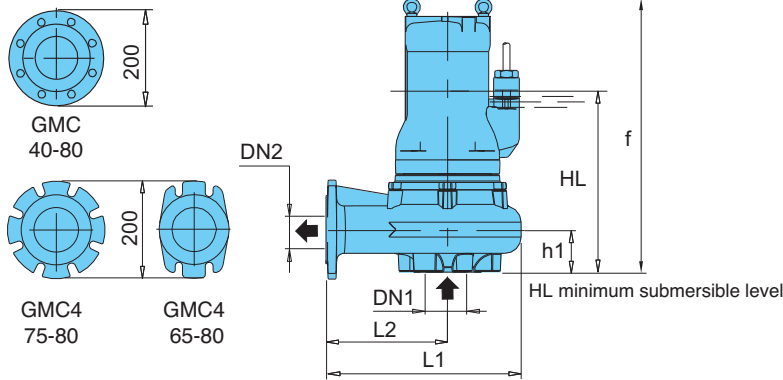

Version with foot and 90° elbow

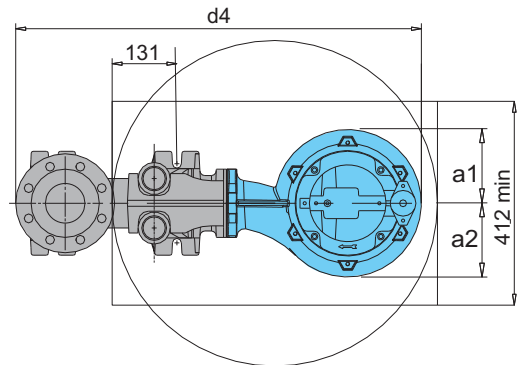
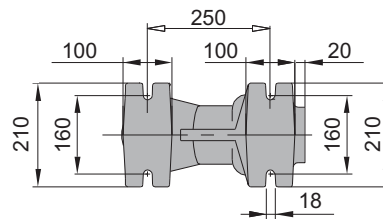
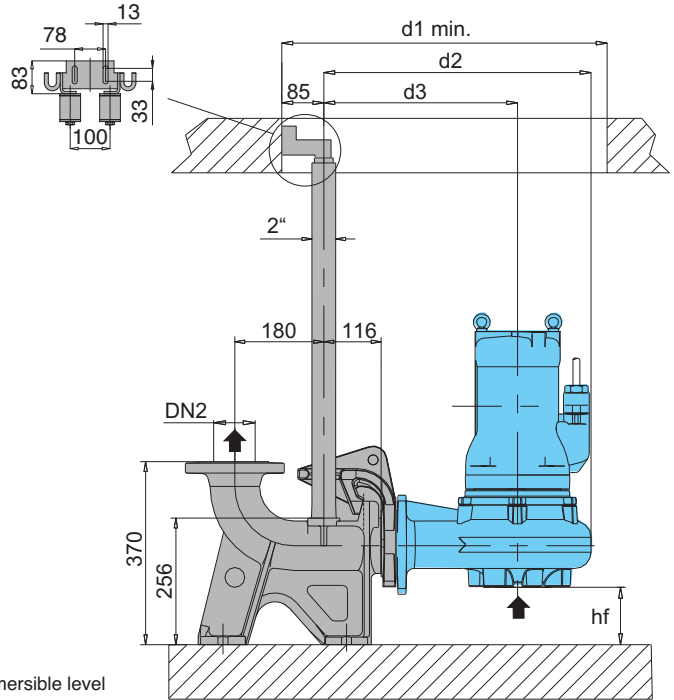

Version with duck foot coupling

TYPE	EN 1092-2 PN 10		Dimensions mm														Weight kg	
	DN1	DN2	f	HL	hf	h1	h2	a1	a2	d1	d2	d3	d4	L1	L2	L3		L4
GMC 40-80D	80	80	890	523	85	116	1040	168	168	750	603	416	883	437	250	323	547	190
GMC 40-80C																		
GMC 40-80B																		
GMC 40-80A																		
GMC4M 65-80C	80	80	533	330	104	100	673	132	132	658	498	366	775	332	200	273	442	49
GMC4 65-80C																		
GMC4 65-80B																		
GMC4 65-80A																		
GMC4 75-80A	80	80	519	360	84	116	659	136	157	658	511	366	791	365	220	293	475	67

Dimensions and weights

GMC4 80-100

GMC4 90-100

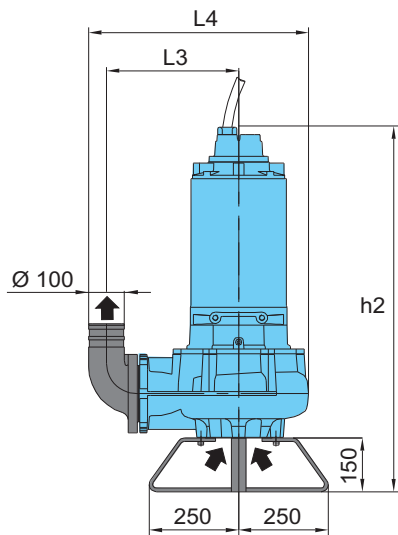
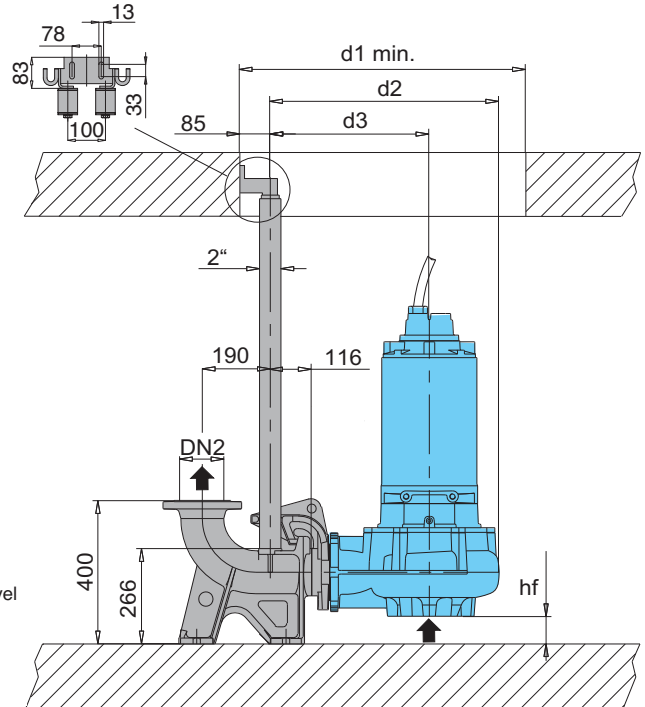
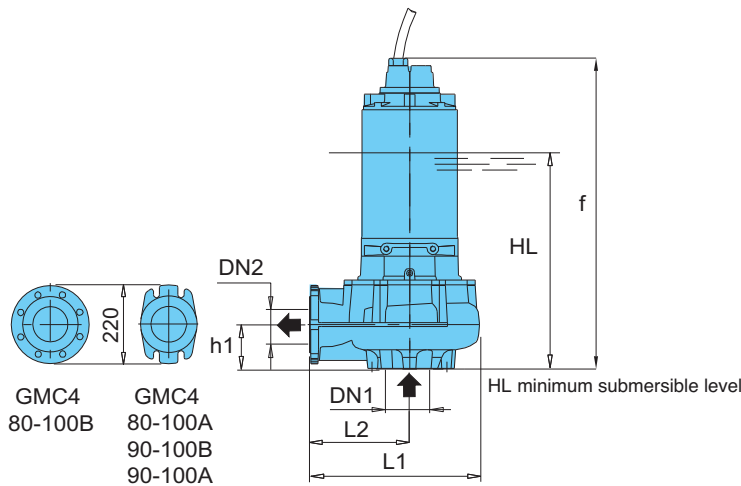

Version with foot and 90° elbow

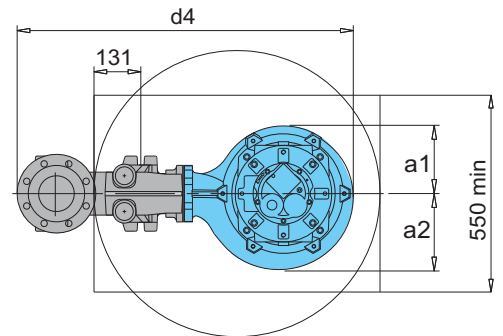
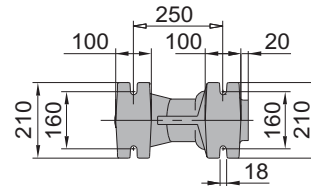

Version with duck foot coupling

TYPE	EN 1092-2 PN 10		Dimensions mm																Weight kg
	DN1	DN2	f	HL	hf	h1	h2	a1	a2	d1	d2	d3	d4	L1	L2	L3	L4		
GMC4 80-100C GMC4 80-100B	125	100	597	420	62	138	747	180	231	850	673	466	973	507	300	390	647	117	
GMC4 80-100A	125	100	852	520	54	147	1002	189	212	800	640	445	940	474	279	369	614	161	
GMC4 90-100B GMC4 90-100A	125	100	920	570	54	147	1070	189	212	800	640	445	940	474	279	369	614	204	

Dimensions and weights

GMC4 100-150

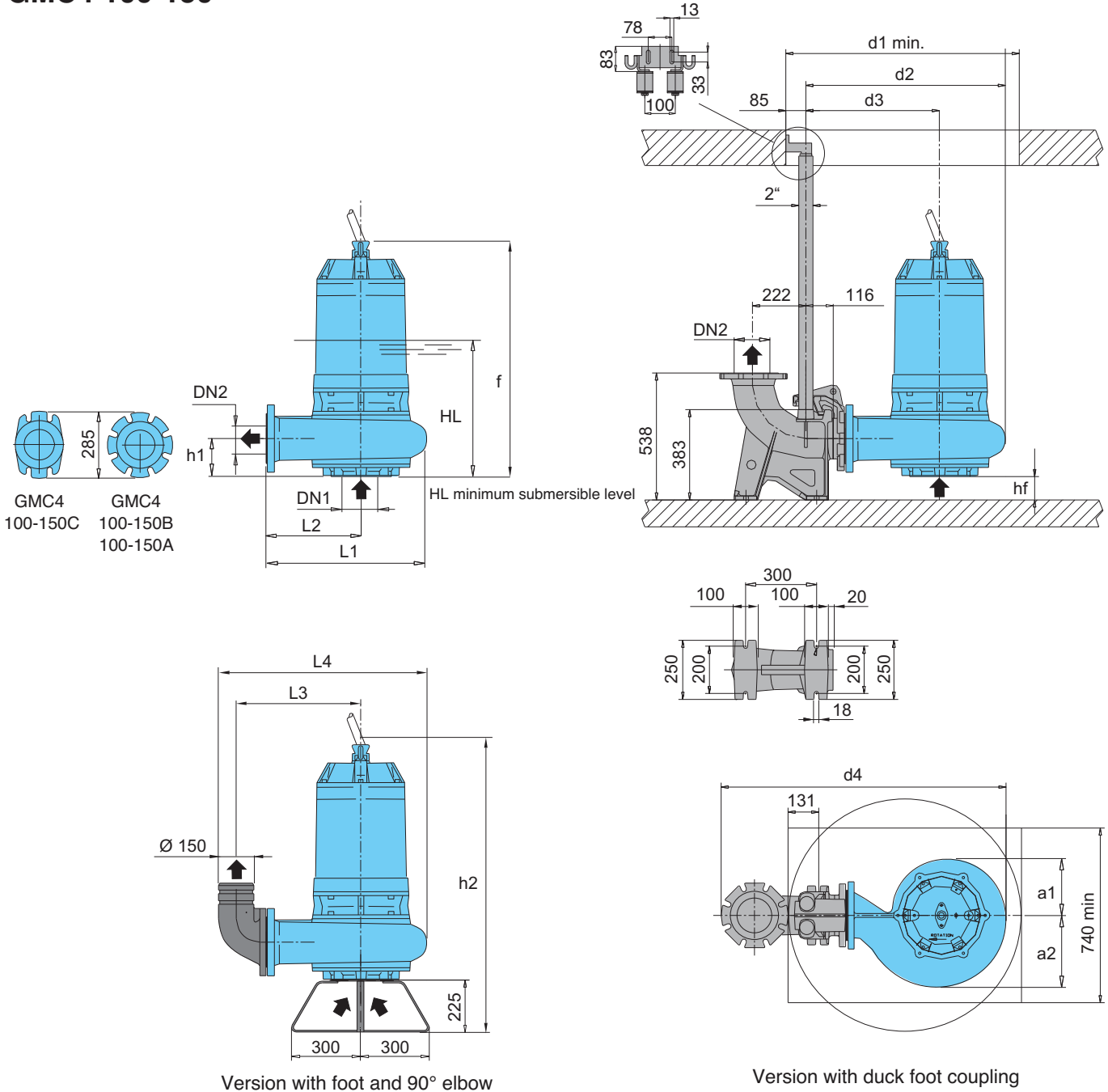

TYPE	EN 1092-2 PN 10		Dimensions mm														Weight kg	
	DN1	DN2	f	HL	hf	h1	h2	a1	a2	d1	d2	d3	d4	L1	L2	L3		L4
GMC4 100-150C	150	150	933	580	113	147	1155	191	223	850	673	467	1038	507	301	431	712	218
GMC4 100-150B/A	150	150	1354	660	80	180	1494	239	304	990	840	566	1208	673	400	530	875	375
GMC4 100-150A/A			1410	760			1632											



Construction

Submersible pumps in **AISI 316** stainless steel.
I-GMV with free-flow (vortex) impeller
I-GMC with single-channel impeller
I-GMN with channels impeller
 Twin mechanical seal with oil chamber (lip-seal motor side up to 2,4 kW 2 poles).
 Delivery connection DN 50-65-80-100-150

Applications

Suitable to pump aggressive and corrosive liquids, particularly to drain waste water in industrial and chemical process plants.
 Solid passage from 30 to 100 mm

Operating conditions

Liquid temperature up to 40 °C.
 Maximum immersion depth: 20 m (with suitable cable length).
 Continuous duty (with pump immersed at minimum level).

Main materials

- Pump casing: stainless steel AISI 316
- Motor casing: stainless steel AISI 316
- Motor cover: stainless steel AISI 316
- Impeller: stainless steel AISI 316
- Shaft: stainless steel AISI 316L
- Screws: stainless steel AISI 316
- Mechanical seal motor side: graphite/ceramic/FPM (lip-seal made of nitrile up to 2,4 kW 2 poles).
- Mechanical seal pump side: silicon carbide/silicon carbide/FPM

Motor

- 2 or 4 poles induction, 50Hz
- Three-phase version: 400V ± 10%, up to 3,2 kW
400/690V ± 10%, over 3,2 kW
- Insulation class: H
- Protection degree: IP 68
- N° of starting x hour: max 15 with regular intervals
- Cable: H07RN-F, length 10 m
- Other models: contact our sale office

Coverage chart

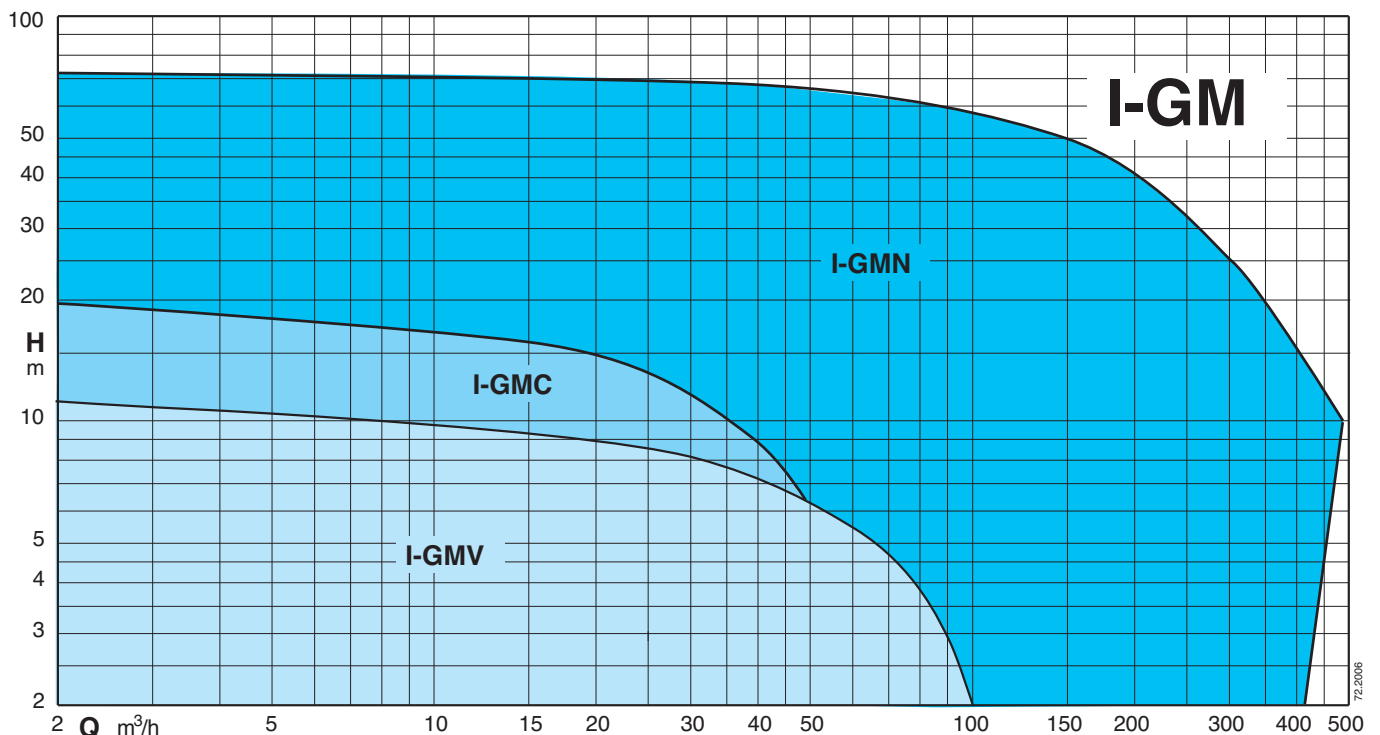

Technical data

TYPE	P ₂ kW	I _N A	Power Supply	r.p.m.	Starting	DN mm	Free passage Ø mm	Thermal protector	Humidity probe	 ATEX Eex
I-GMV 50-50C	1,4	3,5	3~ 400V	2850	D.O.L.	50	50	NO	NO	✓
I-GMV 50-50B/A	1,4	3,5	3~ 400V	2850	D.O.L.	50	50	NO	NO	✓
I-GMV 50-50A/A	2,4	5	3~ 400V	2850	D.O.L.	50	50	NO	NO	✓
I-GMV4 50-65C	1	3	3~ 400V	1450	D.O.L.	65	50	NO	NO	✓
I-GMV4 50-65B	1	3	3~ 400V	1450	D.O.L.	65	50	NO	NO	✓
I-GMV4 50-65A	1,3	3,5	3~ 400V	1450	D.O.L.	65	50	NO	NO	✓
I-GMV4 50-80B	2,3	5	3~ 400V	1450	D.O.L.	80	50	NO	NO	✓
I-GMV4 50-80A	2,8	6,5	3~ 400V	1450	D.O.L.	80	50	NO	NO	✓
I-GMC 40-65B	2,4	5	3~ 400V	2850	D.O.L.	65	40	NO	NO	✓
I-GMC 40-65A	2,9	6	3~ 400V	2850	D.O.L.	65	40	NO	NO	✓
I-GMN 30-65B	3,2	6,5	3~ 400V	2850	D.O.L.	65	30	NO	NO	✓
I-GMN 30-65A	3,2	6,5	3~ 400V	2850	D.O.L.	65	30	NO	NO	✓
I-GMN 30-80B	5,7	12,5	3~ 400/690V	2850	Y/Δ	80	30	●	●	✓
I-GMN 30-80A	5,7	12,5	3~ 400/690V	2850	Y/Δ	80	30	●	●	✓
I-GMN 30-80S	8,2	15,5	3~ 400/690V	2850	Y/Δ	80	30	●	●	✓
I-GMN 40-100D	13,8	29,5	3~ 400/690V	2850	Y/Δ	100	40	●	●	✓
I-GMN 40-100C	13,8	29,5	3~ 400/690V	2850	Y/Δ	100	40	●	●	✓
I-GMN 40-100B	18,2	34	3~ 400/690V	2850	Y/Δ	100	40	●	●	✓
I-GMN 40-100S	22,4	40,1	3~ 400/690V	2850	Y/Δ	100	40	●	●	✓
I-GMN 50-100C	48,2	86,5	3~ 400/690V	2850	Y/Δ	100	50	●	●	✓
I-GMN 50-100B	48,2	86,5	3~ 400/690V	2850	Y/Δ	100	50	●	●	✓
I-GMN 50-100A	48,2	86,5	3~ 400/690V	2850	Y/Δ	100	50	●	●	✓
I-GMN4 60-100B	7,1	13,5	3~ 400/690V	1450	Y/Δ	100	60	●	●	✓
I-GMN4 60-100A	7,1	13,5	3~ 400/690V	1450	Y/Δ	100	60	●	●	✓
I-GMN4 80-100B	11,6	23,2	3~ 400/690V	1450	Y/Δ	100	80	●	●	✓
I-GMN4 80-100A	11,6	23,2	3~ 400/690V	1450	Y/Δ	100	80	●	●	✓
I-GMN4 100-150B	25	48	3~ 400/690V	1450	Y/Δ	150	100	●	●	✓
I-GMN4 100-150A	35,7	65,5	3~ 400/690V	1450	Y/Δ	150	100	●	●	✓

P₂ Rated power output

I_N Rated current

● Standard

✓ ATEX Eex Version on demand

Characteristic curves

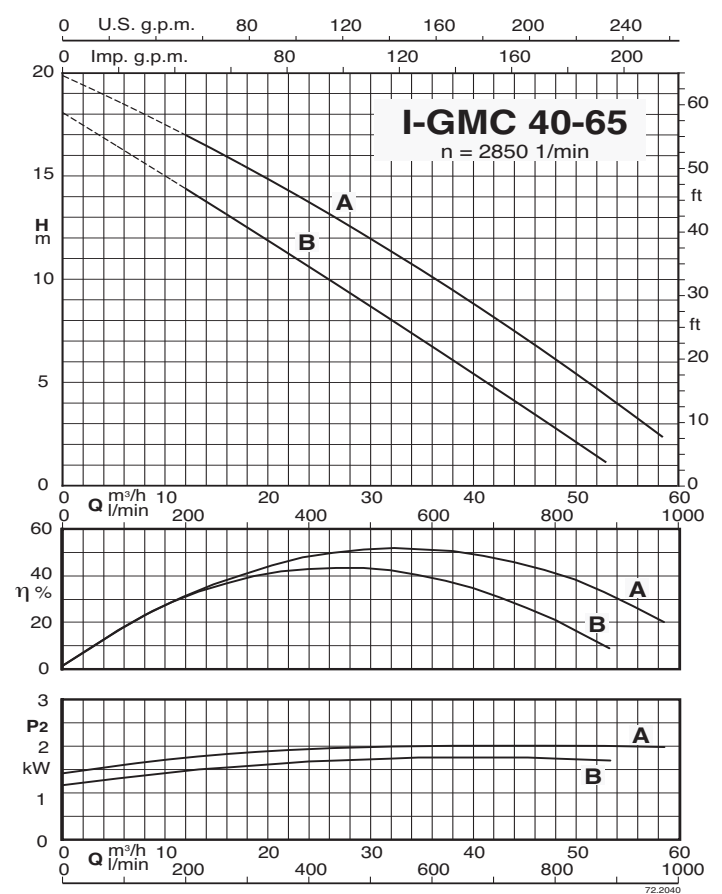
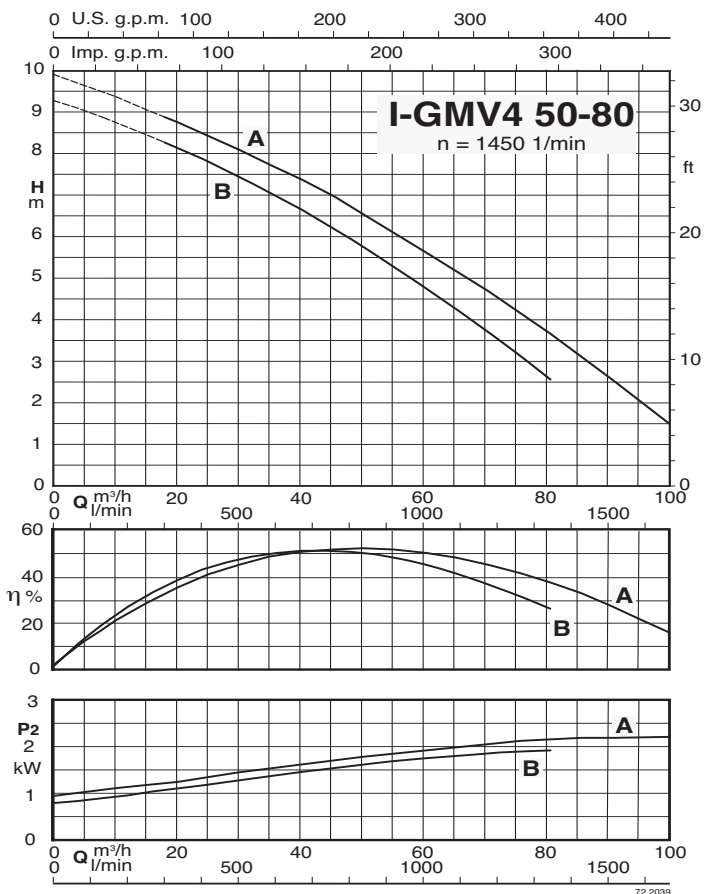
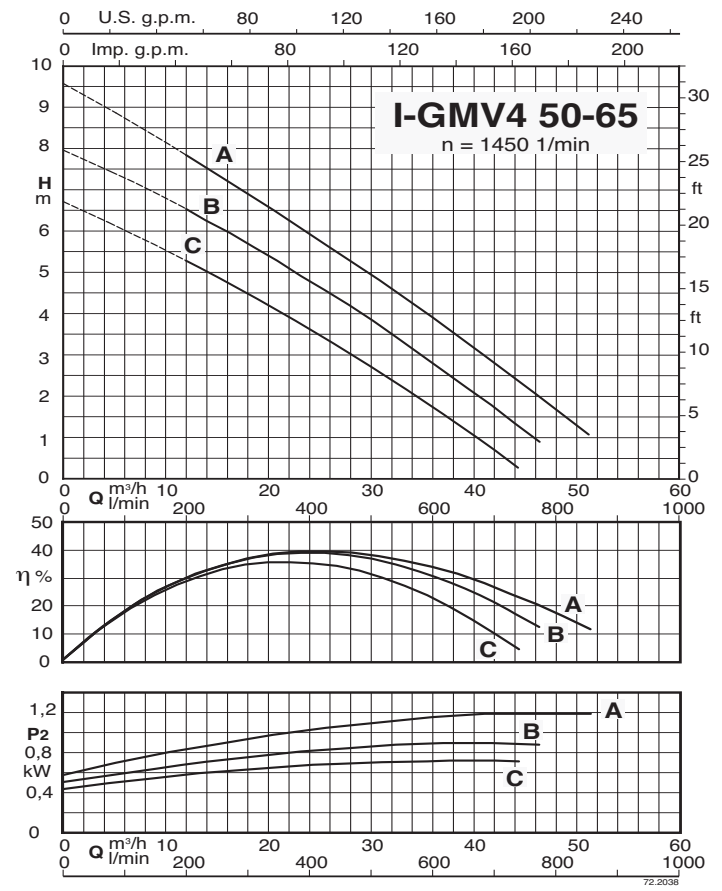
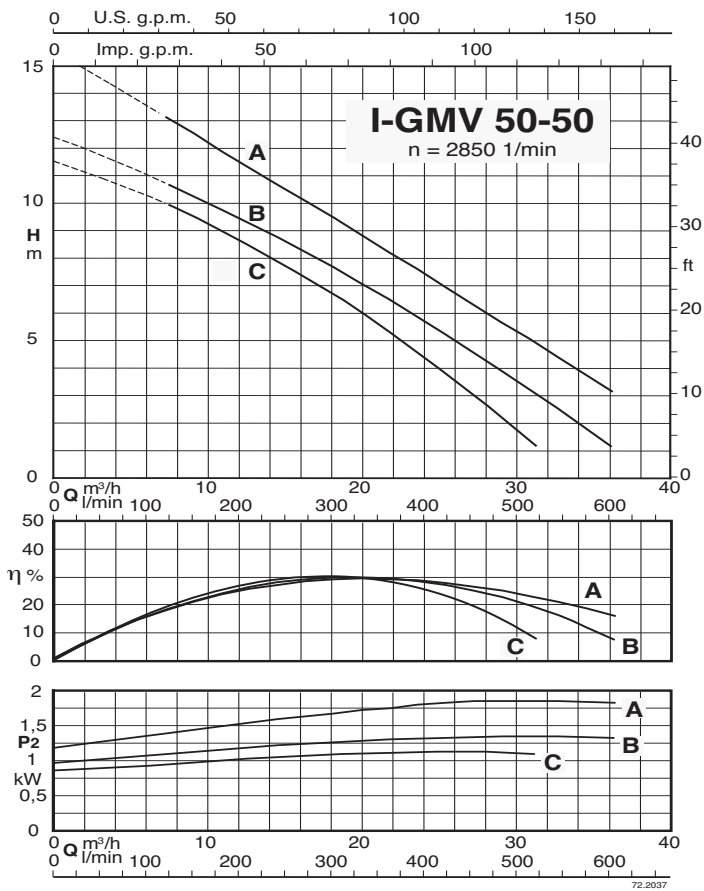



Construction

Submersible pumps, **B 10 bronze marine** version.

B-GMV with free-flow (vortex) impeller

B-GMC with single-channel impeller

B-GMN with channels impeller

Twin mechanical seal with oil chamber (lip-seal motor side up to 2,4 kW 2 poles).

Delivery connection DN 50-65-80

Applications

Suitable to pump industrial waste water in chemical, and process industries, agricultural and marine areas.

Solid passage from 30 to 50 mm

Operating conditions

Liquid temperature up to 40 °C.

Maximum immersion depth: 20 m (with suitable cable length).

Continuous duty (with pump immersed at minimum level).

Main materials

Pump casing, Motor casing, Motor cover: B 10 bronze marine

Impeller: stainless steel AISI 316

Motor shaft: stainless steel AISI 316L

Screws: stainless steel AISI 316

Mechanical seal motor side: graphite/ceramic/FPM (lip-seal made of nitrile up to 2,4 kW 2 poles).

Mechanical seal pump side: silicon carbide/silicon carbide/FPM

Motor

2 or 4 poles induction, 50Hz

Three-phase version: 400V ± 10%, up to 3,2 kW

400/690V ± 10%, over 3,2 kW

Insulation class: H

Protection degree: IP 68

N° of starting x hour: max 15 with regular intervals

Cable: H07RN-F, length 10 m

Other models: contact our sale office

Coverage chart

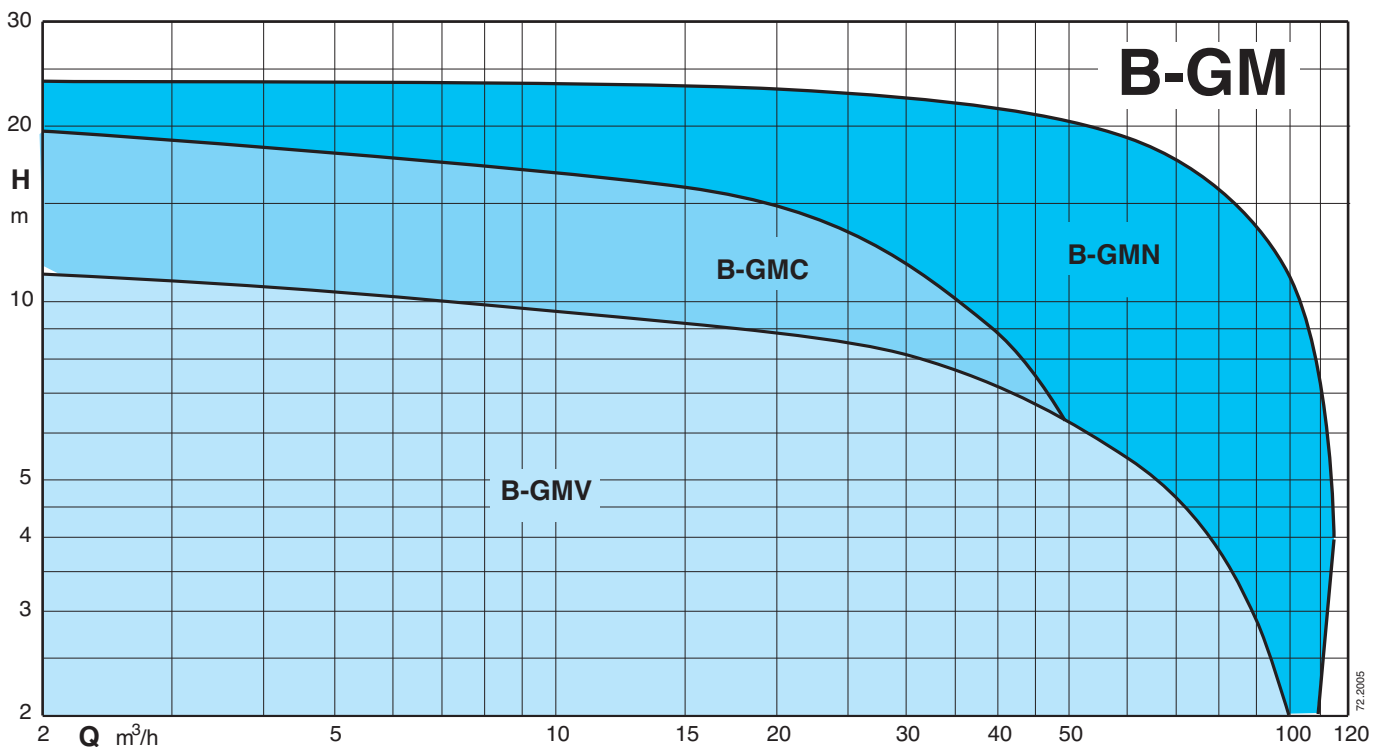

Technical data

TYPE	P ₂ kW	I _N A	Power Supply	r.p.m.	Starting	DN mm	Free passage Ø mm	Thermal protector	Humidity probe	 ATEX Eex
B-GMV 50-50C	1,4	3,5	3~ 400V	2850	D.O.L.	50	50	NO	NO	✓
B-GMV 50-50B/A	1,4	3,5	3~ 400V	2850	D.O.L.	50	50	NO	NO	✓
B-GMV 50-50A/A	2,4	5	3~ 400V	2850	D.O.L.	50	50	NO	NO	✓
B-GMV4 50-65C	1	3	3~ 400V	1450	D.O.L.	65	50	NO	NO	✓
B-GMV4 50-65B	1	3	3~ 400V	1450	D.O.L.	65	50	NO	NO	✓
B-GMV4 50-65A	1,3	3,5	3~ 400V	1450	D.O.L.	65	50	NO	NO	✓
B-GMV4 50-80B	2,3	5	3~ 400V	1450	D.O.L.	80	50	NO	NO	✓
B-GMV4 50-80A	2,8	6,5	3~ 400V	1450	D.O.L.	80	50	NO	NO	✓
B-GMC 40-65B	2,4	5	3~ 400V	2850	D.O.L.	65	40	NO	NO	✓
B-GMC 40-65A	2,9	6	3~ 400V	2850	D.O.L.	65	40	NO	NO	✓
B-GMN 30-65B	3,2	6,5	3~ 400V	2850	D.O.L.	65	30	NO	NO	✓
B-GMN 30-65A	3,2	6,5	3~ 400V	2850	D.O.L.	65	30	NO	NO	✓
B-GMN 30-80B	5,7	12,5	3~ 400/690V	2850	Y/Δ	80	30	●	●	✓
B-GMN 30-80A	5,7	12,5	3~ 400/690V	2850	Y/Δ	80	30	●	●	✓

P₂ Rated power output

I_N Rated current

● Standard

✓ ATEX Eex Version on demand

Characteristic curves

